

Lampe à poser | 220-240 V | 1xE14
8961

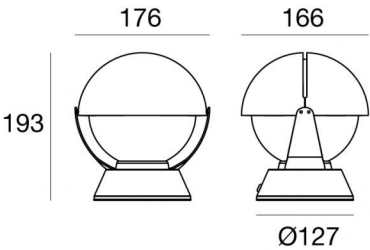

Données techniques	
Designer	Giovanni Luigi Gorgoni
Année de réalisation	1965
Typologie	Lampe à poser
Position d'installation	Sol
Environnement d'installation	Intérieur
Culot de la lampe	1 x E14
Light emission direction	downward and upward
Frequency	50-60 Hz
Classe d'isolation	2
IP	IP20
Essai au fil incandescent	850°
Montage direct sur des surfaces normalement inflammables	Oui
CE	Oui
Article à intensité variable	Non
Orientable	Non
Basculement	Non
Piétinable	Non
Carrossable	Non
Câble inclus	Oui
Prise électrique	Tipo L
Longueur du câble	2 m
Revêtement en résine	Non
Poids net	0.85 Kg

Finition corps	
Matériau	métal
Couleur	blanc gaufré RAL 9003
Fabrication	Vernissage
Finition diffuseur	
Matériau	métal
Couleur	blanc gaufré RAL 9003
Fabrication	Vernissage
Finition base	
Matériau	métal
Couleur	blanc gaufré RAL 9003
Fabrication	Vernissage

Lampe à poser | 220-240 V | 1xE14
8961

Double emission table lamps for indoor application. LED lamplamp included, lamp cap 1xE14.

The device body is made of metal and features a embossed white ral 9003 finish, processed by means of coating; the diffuser is made of metal with a coating treatment. The ingress protection degree is IP20; the total weight is of 0.85 kg.

. The power supply cable is included and features a 2 m lenght.

The device features protection class II and can be floor-mounted.

Compliant with the EN 60598-1 standard and its specific provisions.

Classe d'efficacité énergétique	
Ce produit contient une source lumineuse de classe d'efficacité énergétique E.	

Caractéristiques Techniques de l'éclairage	
Flux lumineux (source)	470 lm
Température de couleur	2700 K
Indice de rendu chromatique	80 Ra

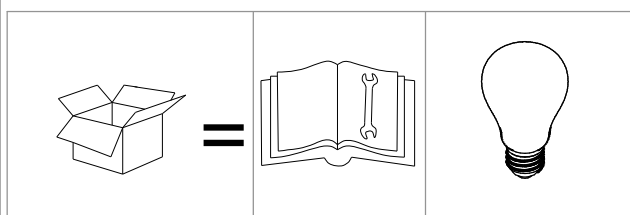
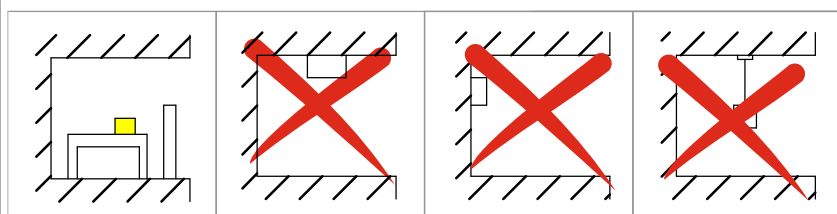
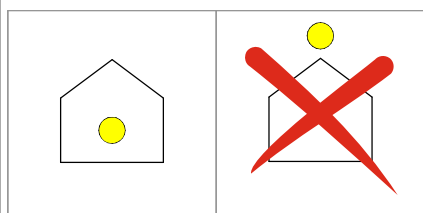
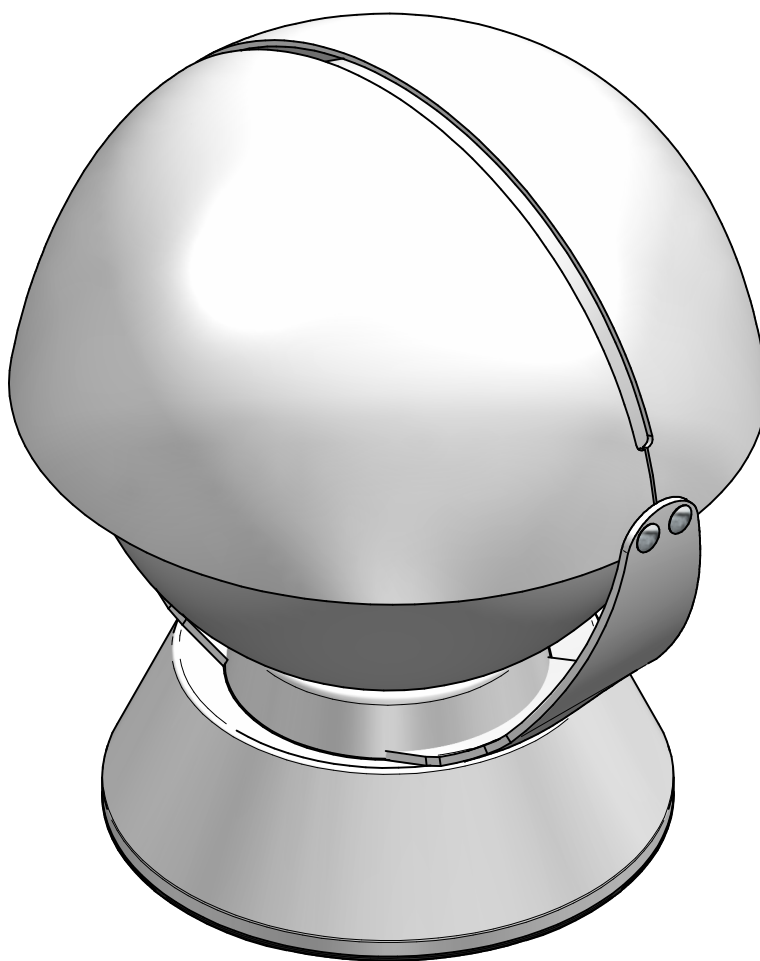

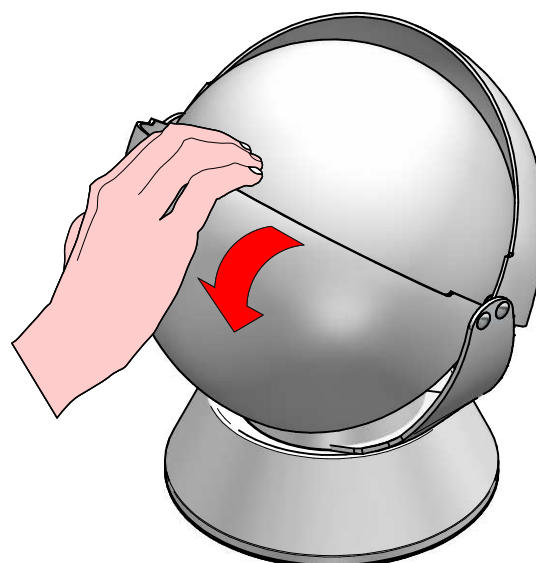
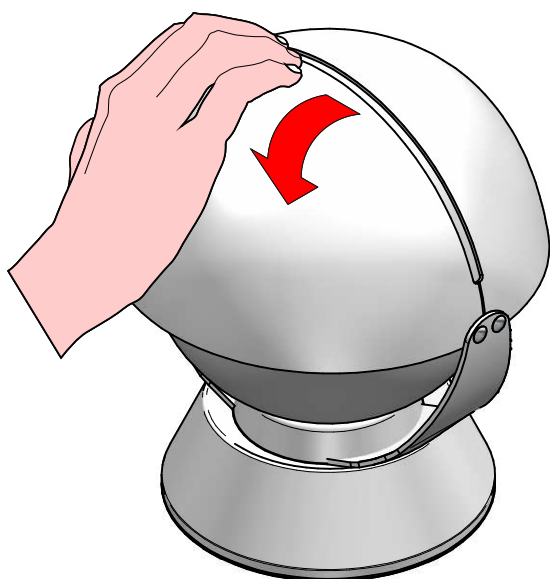
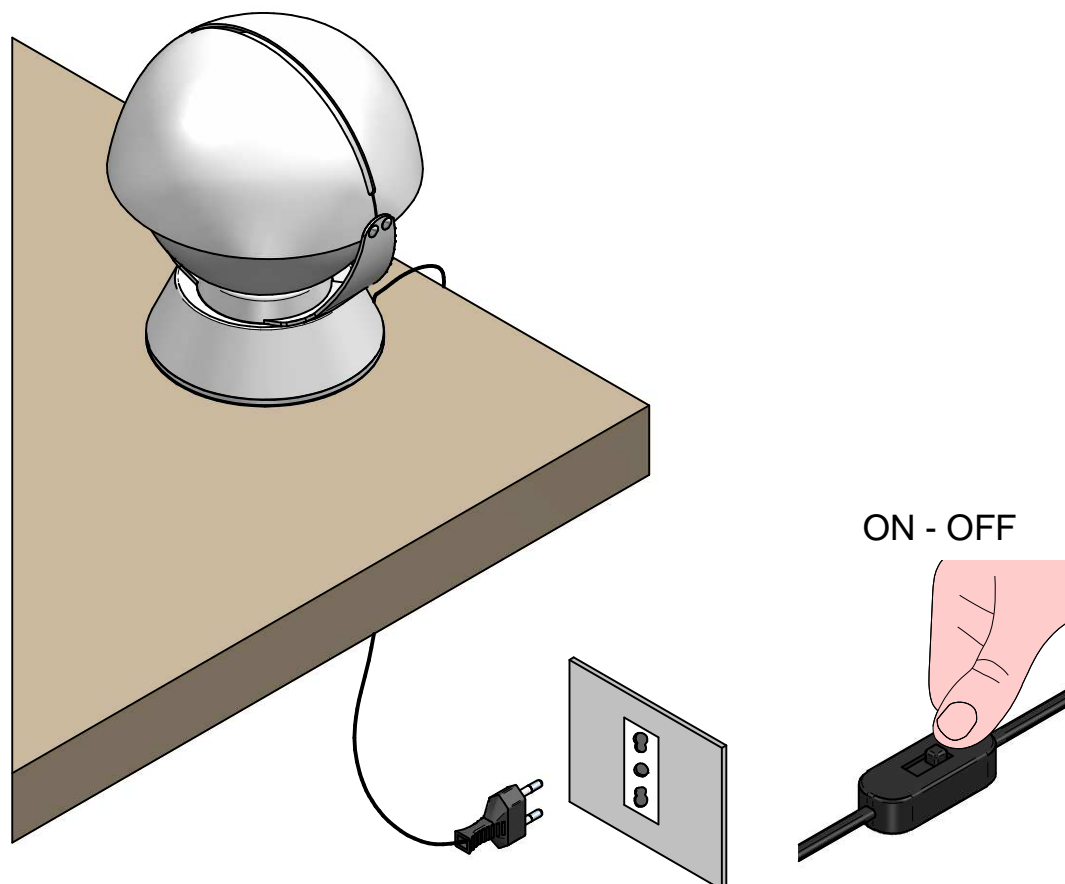

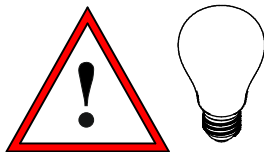

1

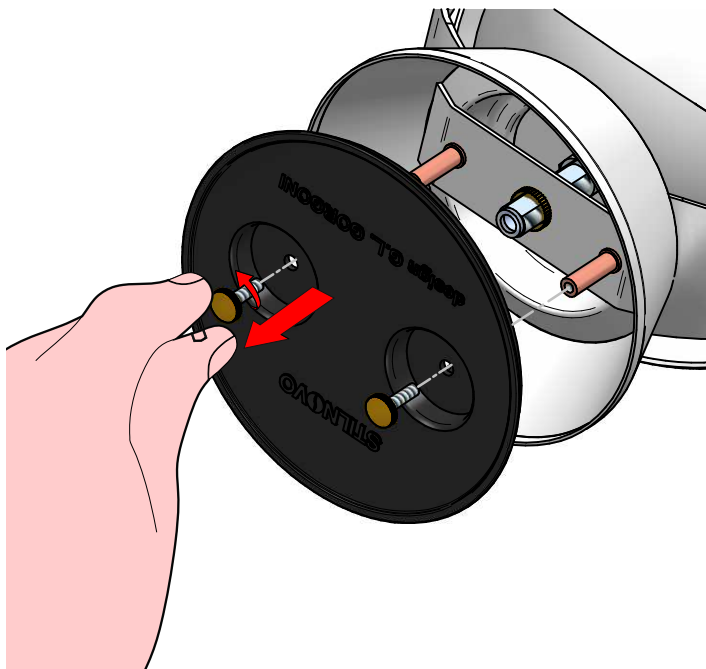

2

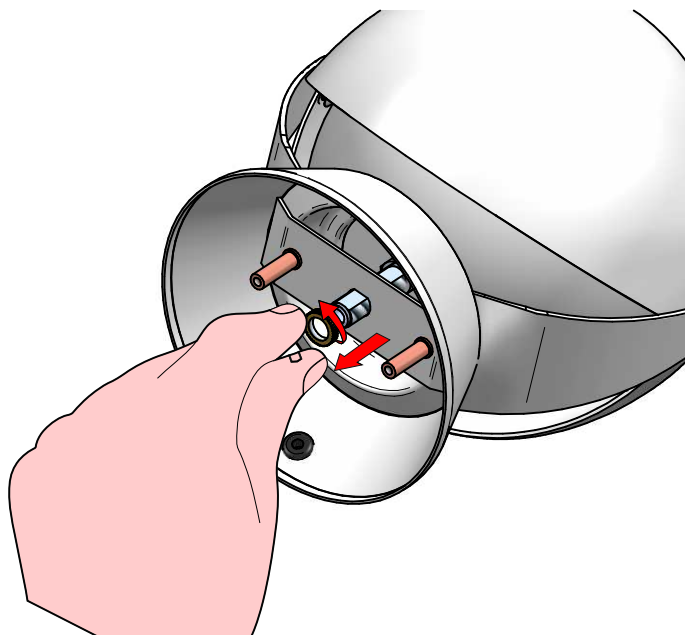

3

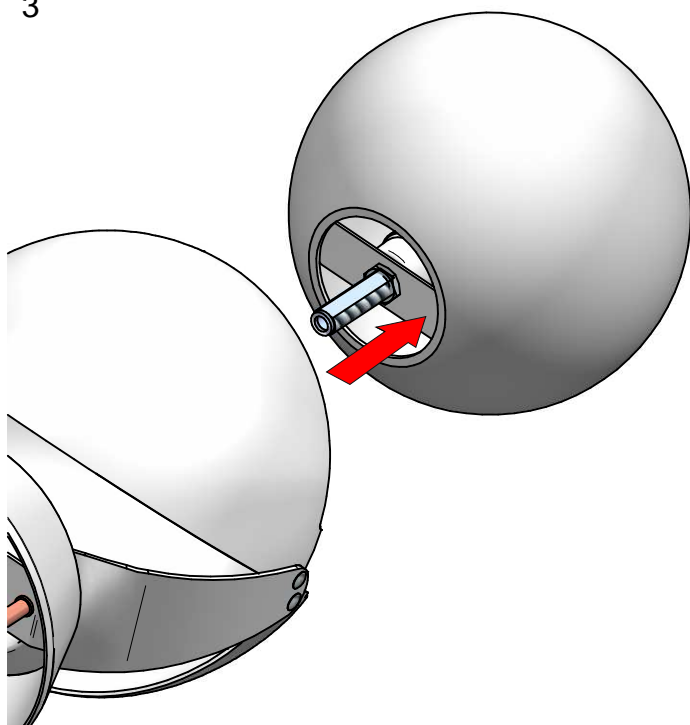

4

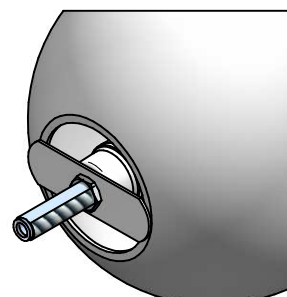
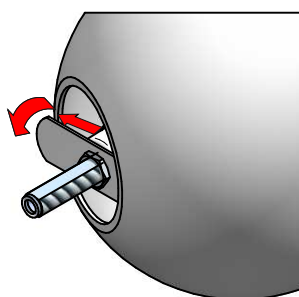
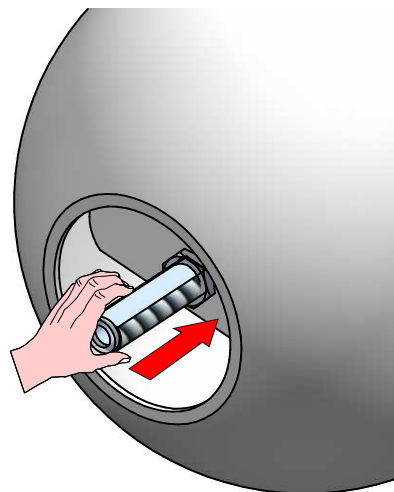

5

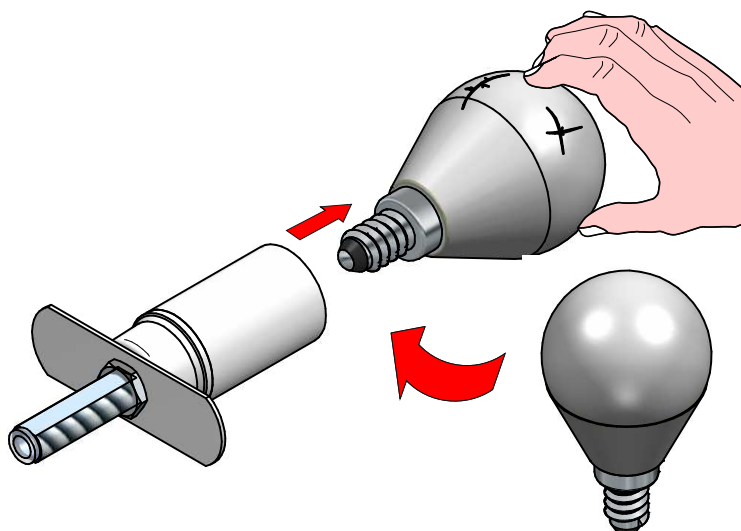

6

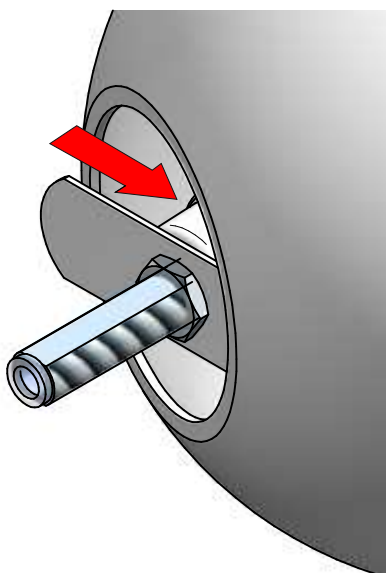

7

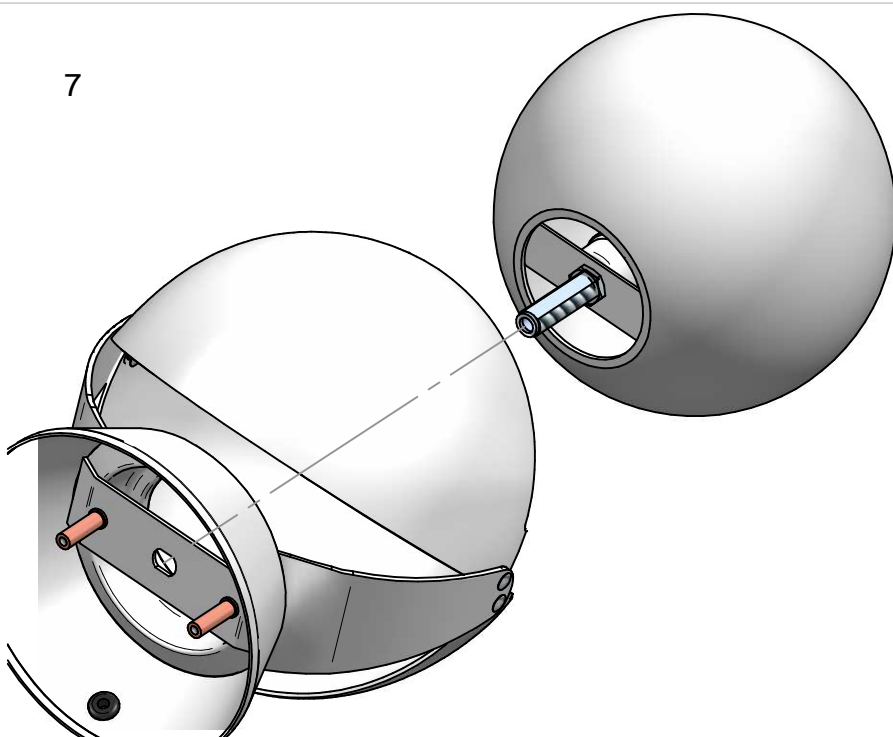

8

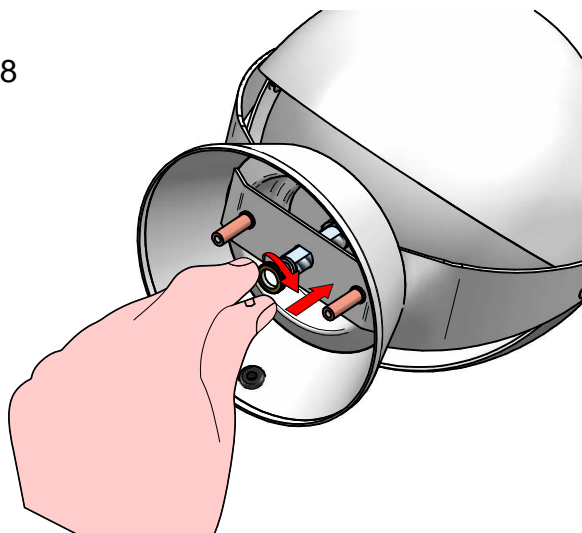

9

